

Project Configuration Sheet – SPV3301-nn

VESA 75/100 Mount SpacePole VESA 75/100 Display Screen Mount Version 1.4

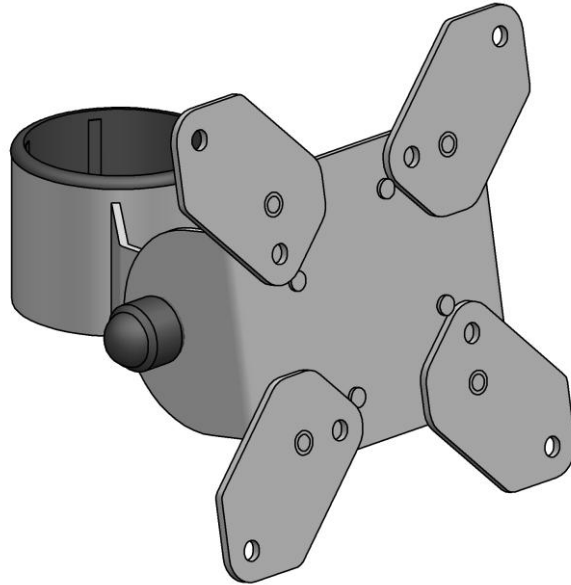

Parts List

Part No.	Description	Qty	Assemble	Box
SP2-7101	SP2 Pole Mount Locking Connection Arm, 56mm, with Bolt Caps (M22116-02)	1	1	1
4118081	Adjustable VESA 75/100 (4 x M9931-0004, 4 x M9941-0004, 4 x M22114-02), with 4x M4x10mm and 4x M4x6mm screws (MK8-0003)	1	1	1

Installation Guide

MK15-0177

Box 36x packed in Master Box B007

Box Label MK15-0029 – SPV3301-nn – V 1.4 (place on each item)
MK15-0026 – 36x SPV3301-nn, VESA75/100 Mount – SpacePole VESA75/100 Display Screen Mount - V 1.4

Colour	<nn>	01	Light Grey
		02	Black
		03	Silver
		04	Pearl
		05	Iron Grey